



26 Roman Court

St Peters Park, Wallsend, NE28 7JP

** TWO BEDROOM TOP FLOOR APARTMENT ** SPACIOUS LOUNGE/ DINING ROOM **

** ALLOCATED PARKING BAY & COMMUNAL GARDENS ** SECURE INTERCOM ENTRY SYSTEM **

** EXCELLENT ROAD LINKS ** BUS SERVICES INTO NEWCASTLE CITY CENTRE & THE COAST **

** AVAILABLE NOW FURNISHED ** DEPOSIT £745 ** COUNCIL TAX BAND A ** ENERGY RATING C **

£695 Per Month

26 Roman Court

St Peters Park, Wallsend, NE28 7JP



- Two Bedroom Top Floor Apartment
 - Available Now - Furnished
 - Deposit £745
- Secure Intercom Entry
 - Excellent Road Links
 - Council Tax Band A
- Allocated Parking & Communal Garden
 - Bus Services To Newcastle & The Coast
 - Energy Rating C

Communal Entrance

Lobby

Hallway

Lounge/Dining Room
14'1" x 15'1" (4.29 x 4.59)

Kitchen
8'6" x 8'10" (2.60 x 2.69)

Bathroom
5'2" x 8'10" (1.57 x 2.70)

Bedroom 1
11'4" x 8'10" (3.46 x 2.69)

Bedroom 2
7'8" x 9'6" (2.34 x 2.89)

- Externally
- Broadband and Mobile
- Flood Risks
- Reservation
- Example
- Obligations

PROPERTYMARK

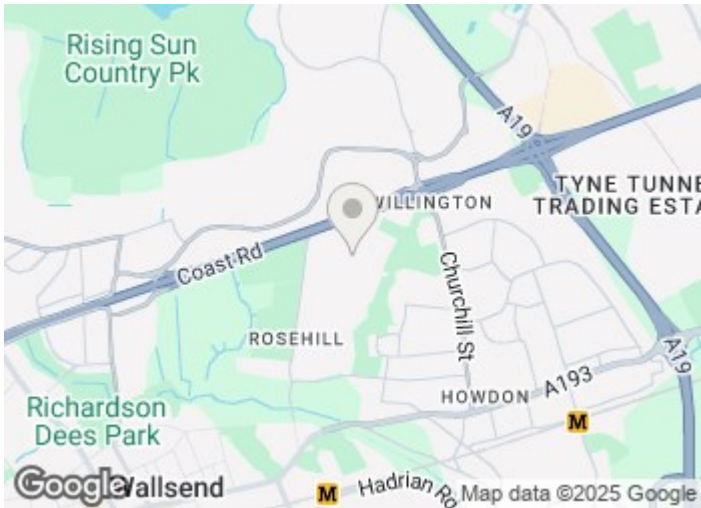

Directions





Floor Plan

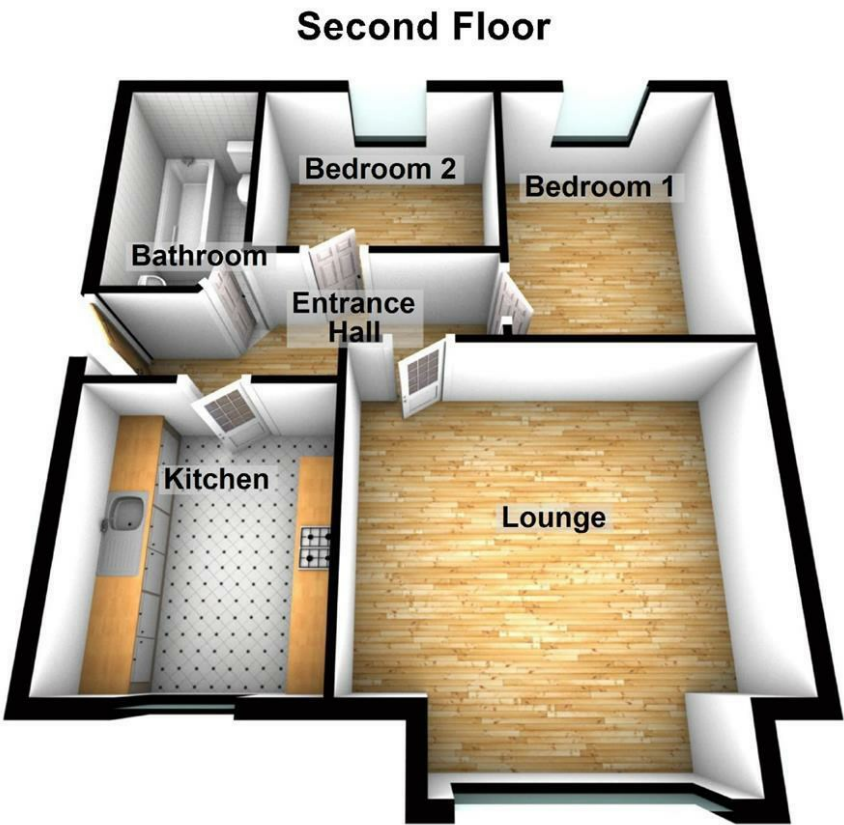

These particulars, whilst believed to be accurate are set out as a general outline only for guidance and do not constitute any part of an offer or contract. Intending purchasers should not rely on them as statements of representation of fact, but must satisfy themselves by inspection or otherwise as to their accuracy. No person in this firms employment has the authority to make or give any representation or warranty in respect of the property.

Energy Efficiency Rating		
	Current	Potential
Very energy efficient - lower running costs		
(92 plus) A		
(81-91) B		
(69-80) C	74	76
(55-68) D		
(39-54) E		
(21-38) F		
(1-20) G		
Not energy efficient - higher running costs		
England & Wales	EU Directive 2002/91/EC	